

SATURN

Strapping Systems



Model SA-3350 Arch Strapper

Highlight's Saturn SA-3350 is the simplest and most user friendly arch strapping system, capable of cycle speeds up to 30 straps per minute. Simply align the product to the center of the arch and trigger the start button. The machine will tension, heat seal, and secure your products by applying an adjustable force from 5 pounds to 120 pounds.

The SA-3350 is designed to operate semi-automatically with the push-activated start button or foot switch. The Model SA-3350 was specifically designed to eliminate common problems with strapping machines and provide trouble free use at an economical price.

Easy and simple strapping!

HIGHLIGHTS

- » Built-in sensor in the table top allows completely automatic operation for performing rapid successive straps
- » Dependable design provides years of reliable service with low maintainance
- » Internally mounted strap coil for compact machine size and operator safety

PREMIUM FEATURES

Automatic Operation

The Saturn SA-3350 is equipped with a built-in sensor to switch to complete automatic operation when strapping multiple cases successively, or when executing quick four-sided strapping on boxes for extra security.

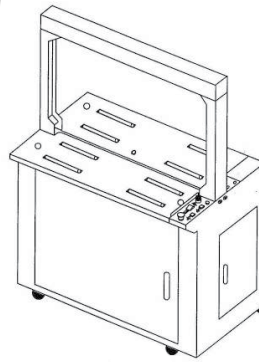

Locking Swivel Casters

Highlight's heavy duty locking casters allow the Saturn SA-3350 to be easily moved around a facility to a work area, or moved aside when not in use.



Heavy Duty Design

All-steel construction, sturdy design, and powder-coated surfaces make the Saturn SA-3350 durable and reliable for years of industrial use.

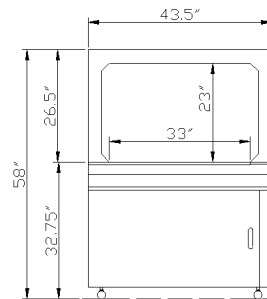

Easy-to-use Controls

Simple controls make strapping virtually any product simple and consistent.



SIMPLE CONTROLS

- Power On/Off
- Start
- Stop
- Strap Tension Dial
- Strap Forward/Reverse
- Foot Switch
- Emergency Stop
- Automatic Strap Cycle Sensor

SYSTEM SPECIFICATIONS

Machine Type	Arch Strapper	Arch Size	3" wide, custom height
Strap Tension	Adjustable 5 to 120 Pounds	Strapping Speed	Up to 30 Straps per minute
Strap Type	Polypropylene	Machine Dimensions	60" L, 22" W, 48" H, depending on arch
Strap Thickness	3/8" or 1/2", adjustable	Electrical	120 V, 60 Hz, 4 Amp
Strap Coil Size	Accepts 8" or 9" ID by 8" Wide	Machine Weight	400 Pounds

Contact:

HIGHLIGHT
INDUSTRIES, INC.

2694 Prairie SW
Wyoming, Michigan 49519
800-531-2465